

Installation type

■ Brackets

Bracket installation. There are 4 type of installations :

Wall Mount :

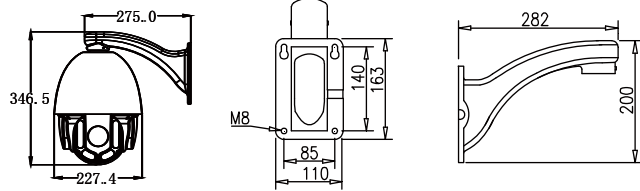

Corner Mount :

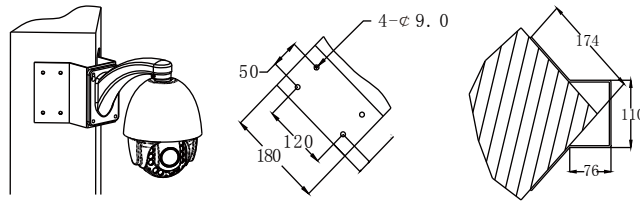

Pole Mount :

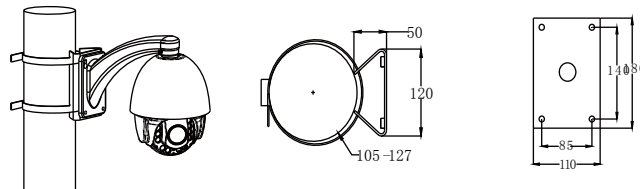

Pendant Mount :

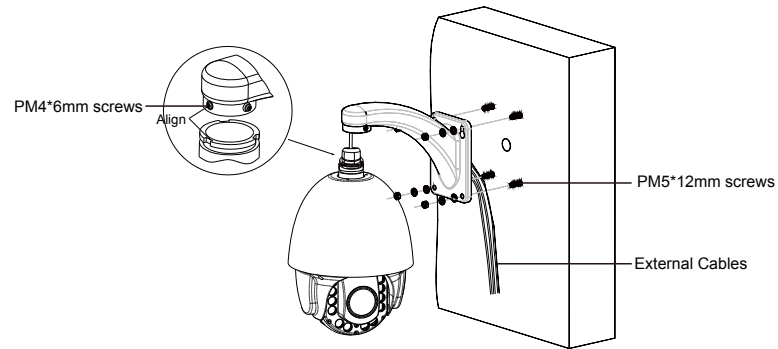
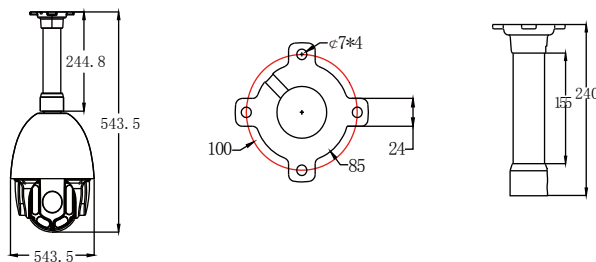

Note: Cables can be lead through from wall hole or bracket sides.

Table of functions

Speed Dome supports shortcut command to achieve partial functions (Only for PELO-D \ P agreement)

Function	Shortcut command (Goto Preset No.)
Turn off Light sensor	150
Turn on Light sensor	151
Turn off Infrared light	154
Infrared light low beam	154
Infrared light high beam	155
Turn on Infrared light low beam \ high beam	156
Turn off Zoom linkage	157
Turn on Zoom linkage	158
Turn off Black & White/Color Zoom linkage	159
Turn on Black & White/Color Zoom linkage	160
Set the left margin of the 1st area scan	161
Set the right margin of the 1st area scan	188
Set the left margin of the 2nd area scan	189
Set the right margin of the 2nd area scan	190
Set the left margin of the 3rd area scan	191
Set the right margin of the 3rd area scan	192
Set the left margin of the 4th area scan	193
Set the right margin of the 4th area scan	194
Run the 1st scan area	195
Run the 2nd scan area	196
Run the 3rd scan area	197
Run the 4th scan area	198
Continuous operation level scan	199
Run 1st cruise	200
Run 2st cruise	201
Run 3st cruise	202
Run 4st cruise	203
Erase the 1st cruise queue	204
Erase the 2nd cruise queue	205
Erase the 3nd cruise queue	206
Erase the 4nd cruise queue	207
Run the 1st scan pattern	208
Run the 2st scan pattern	209
Run the 3st scan pattern	210
Run the 4st scan pattern	211
Record the 1st scan pattern	212
Record the 2st scan pattern	213
Record the 3st scan pattern	214
Record the 4st scan pattern	215
End Recording scan parrern	216

Installation Guide

■ Wall Mount

1. Check the intensity of wall. Recommended load-bearing capacity of the wall should be 8 times the weight of speed dome plus accessories.
2. Mark installation position: Use the template to do stand base, mark the location of the mounting holes on the wall.
3. Bracket installation: First, lead out the control cable, network cable, power cable from bracket, and mount the bracket by 4 screws on wall.
4. Speed Dome installation: assemble speed dome to bracket, make sure the bracket teeth well matched to speed dome 3 slots, and clockwise rotation to tighten screws.

Network IR Speed Dome Camera

• Easy Guide Manual •



IP Surveillance

2014 AUG V1.1

Features

- Adapt high quality motor with less heat and no tremble during low speed revolve.
- Low temperature Power on protection.
- Fast connectors, easy install.
- Stepless , Horizontal: 360°(Continuous);Vertical: 90° (180° Auto Flip).
- 255 Preset position , ±0.1°
- 180°/s Speed of preset position.
- 8 cruises , 32 preset positions/cruise.
- 8 Pattern scan , 8 Zone/ Horizontal scan.
- IR range: 100M
- Auto matching of focal length and rotation speed.
- Auto operation record, avoid power failure lost.
- RS485 compatible to PELCO D/P.
- Return to automation after manual operation.
- S/W interface update.
- Previous position memory function, reboot after power failure to return to previous position.
- IP66 design with built-in automatic thermostat.
- Lightning & Surge proof.
- Built-in alarm; alarm priority setting, Alarm trigger method and preset positions, Alarm timer lifting function.

Dip Settings

This sector is for protocol \ serial baud rate \ speed dome position setting.

◆ Position of Dip switch is as below figure.

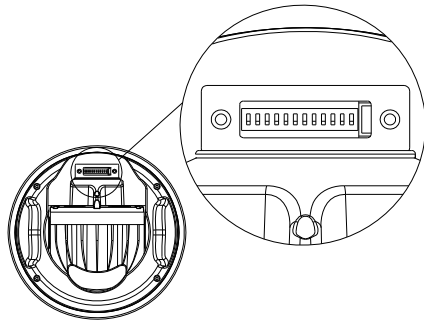

Note : the serial baud rate of both speed dome and Network server should be the same, default value is preset, Please do not revise. If a revise is necessary.

Dip switch first 1~8 bits for address, 9~10 bits for protocol, 11~12 bits for serial baud rate, default value is 9600bps.

Setting method as below:

Baud Rate	Switch Digits					
	1	2	9	10	11	12
9600					OFF	ON

This speed dome supports multiple protocol, Protocol setting as below figure.

PROTOCOL	Switch Number					
	1	2	9	10	11	12
PELCO_PD			ON	ON		

Factory Default:

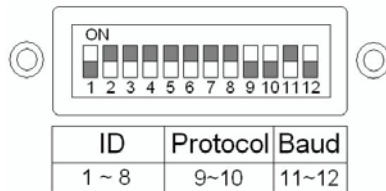

◆ Speed Dome Address Setting: Control command includes speed dome address. Speed Dome only react to the commnad of its own IP address. Via Dip switches 1~8 to change, not via user inter face. Fixed address from 1 to 254.

ID	B1	B2	B3	B4	B5	B6	B7	B8
1	ON							
2		ON						
3	ON	ON						
4			ON					
5	ON		ON					
6		ON	ON					
7	ON	ON	ON					
8				ON				
9	ON			ON				
10		ON		ON				
.....								
254		ON	ON	ON	ON	ON	ON	ON

Installation

When user login IP address, Client S/W will be automatically asked to install. Before login, please make sure the downloading Active X functions are permitted to Network security settings, or adjust the security level.

Control settings :

1. Open IE browser;
2. Download Controls;
3. Select control package to download, and install.

Login IP camera

- Input the IP cam address at URL of browser, and User ID and Password. The default value to login IP speed dome as below. If no ID & Password requested, just input IP address is ok.

IP	192.168.1.221
ID	admin
PW	admin

Note 1 : IP address of PC and IP camera should be at same Network segment.

Note 2 : The proposed setup is complete, change and save securely the password.

Safety Precautions

■ Safety Precautions :

- ※ Do not attempt to disassemble, in case electric shock. Unless assigned qualified technician, otherwise, please do attempt for maintenance.
- ※ The installation should be performed by qualified service personnel shall comply with all local regulations.
- ※ Please refer to the appropriate installation safety norms.
- ※ Please note the requires installation environment of this product.
- ※ Using a reliable tool, a poor quality tool might cause product damage, but also personal and property damage.
- ※ Check before installation. The recommended installation site and intensity of the strength should be greater than the weight of the IP Speed Dome and accessories integrated 8 times.
- ※ Please keep the attached packing materials for future use.

■ Warm :

- ※ Prohibit the storage or use of highly flammable, explosive materials in the danger zone to install and use the product.
- ※ In the product installation must strictly comply with the national electrical safety procedures and the use of the region.
- ※ Confirm the installation process you might come into contact with a fixed mounting position near the power supply and the power of this product has been disconnected.
- ※ Voltage to this product is AC24V, any voltage above this value is prohibited.
- ※ This product must not be installed or used in excess of the requirements of environment.
- ※ All outlets must have waterproof.
- ※ Make sure ground wire to ground and resistance less than 4Ω to gain the best surge protection.

External Wiring

1. Standard

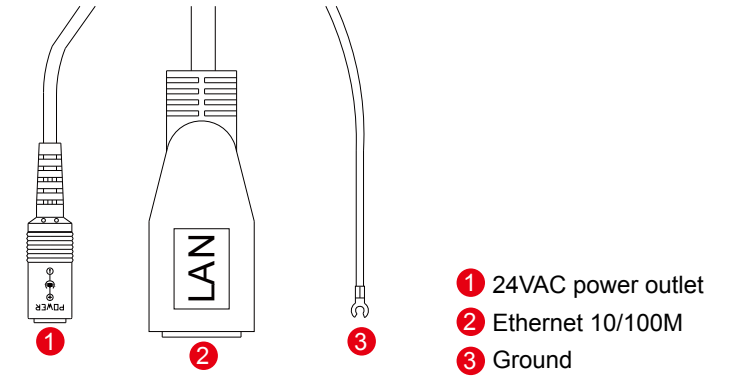

2. Full Functional

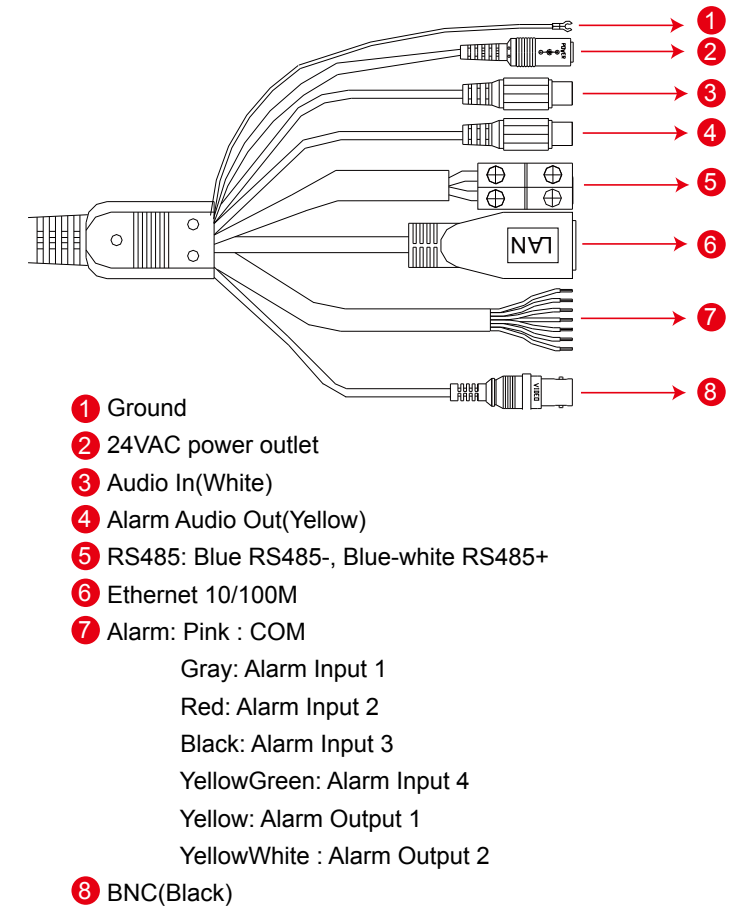

Power Outlet :

